

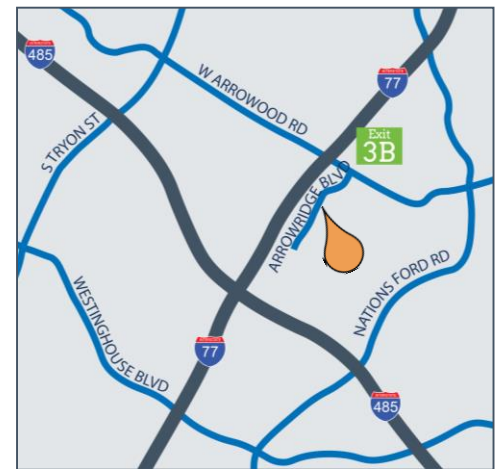

Property Features

- < 48,698 SF
- < 16' clear height
- < Rear loading dock location
- < Zoned I-1
- < Located just inside the I-485 loop, off I-77

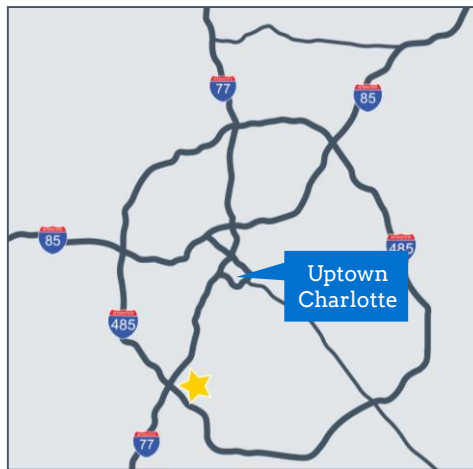

AVAILABILITY	
Suite Q	7,290 SF Total / 2,319 SF Office
Suite T	4,908 SF Total / 1,582 SF Office

8107-Q Arrowridge Boulevard

Floor Plan

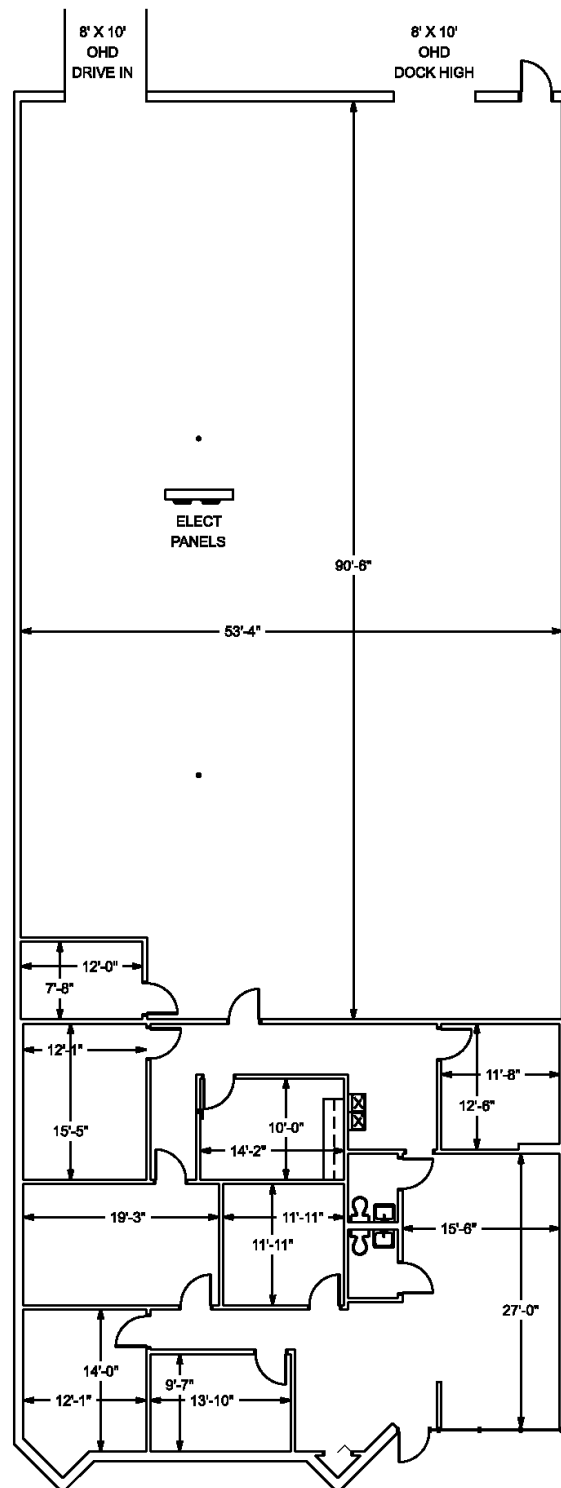

Space Details

- ◀ 7,290 SF total
- ◀ 2,319 SF of office space
- ◀ One (1) 8' x 10' loading door
- ◀ One (1) 8' x 10' drive-in door